



72 Ravenslea
Ravenstone, Coalville, LE67 2AW

£200,000



Brief Description

Available with NO UPWARD CHAIN on Ravenslea, Ravenstone, this delightful three-bedroom semi-detached house offers an EXCELLENT OPPORTUNITY for those seeking a SPACIOUS family home. With generous bedrooms, a beautifully established garden, off-road parking and a modern kitchen diner, this property is well-priced for its size and potential.

Upon entering, you are welcomed by an entrance hall that leads directly into the OPEN-PLAN dining kitchen. This inviting space features a range of MODERN cream wall and base units, providing ample storage. The kitchen is equipped with an integrated oven and grill, a dishwasher, and has space for a fridge freezer. The wood laminate flooring adds a CONTEMPORARY touch, while the window overlooking the rear garden allows natural light to flood in. Two stylish pendant lights and a metro tiled splashback enhance the kitchen's appeal. Adjacent to this area is a separate UTILITY room, complete with a ground floor WC and plumbing for a washing machine, ensuring practicality for everyday living.

The spacious BAY-FRONTED living room continues the theme of elegance with its wooden flooring, feature wall panelling, and a cosy fireplace housing a gas fire, making it the perfect spot for relaxation.

Upstairs, you will find three bedrooms, including two GENEROUSLY SIZED doubles that offer ample space for free-standing wardrobes. The third bedroom is a single, featuring a built-in storage cupboard. The family bathroom, currently separate from the WC, presents an OPPORTUNITY for modernisation to suit your personal taste.

The BEAUTIFULLY ESTABLISHED rear garden is a true highlight, boasting a variety of mature trees, plants, and shrubs, along with a paved pathway and a patio seating area, ideal for outdoor entertaining. The garden is enclosed by a fence, providing privacy and security, with side gate access for convenience. To the front, a gravel driveway offers OFF-ROAD PARKING for multiple vehicles.





ON THE FIRST FLOOR

Entrance Hall

Kitchen Diner
9'6" x 16'3" (2.90m x 4.95m)

Utility / WC

Living Room
11'1" x 14'5" (3.38m x 4.39m)

ON THE FIRST FLOOR

Landing

Bedroom 1
10'7" x 12'11" (3.23m x 3.94m)

Bedroom 2
12'5" x 10'11" (3.78m x 3.33m)

Bedroom 3
7'1" x 9'7" (2.16m x 2.92m)

Family Bathroom

Separate WC

ON THE OUTSIDE

Rear Garden

Driveway





Floor Plan

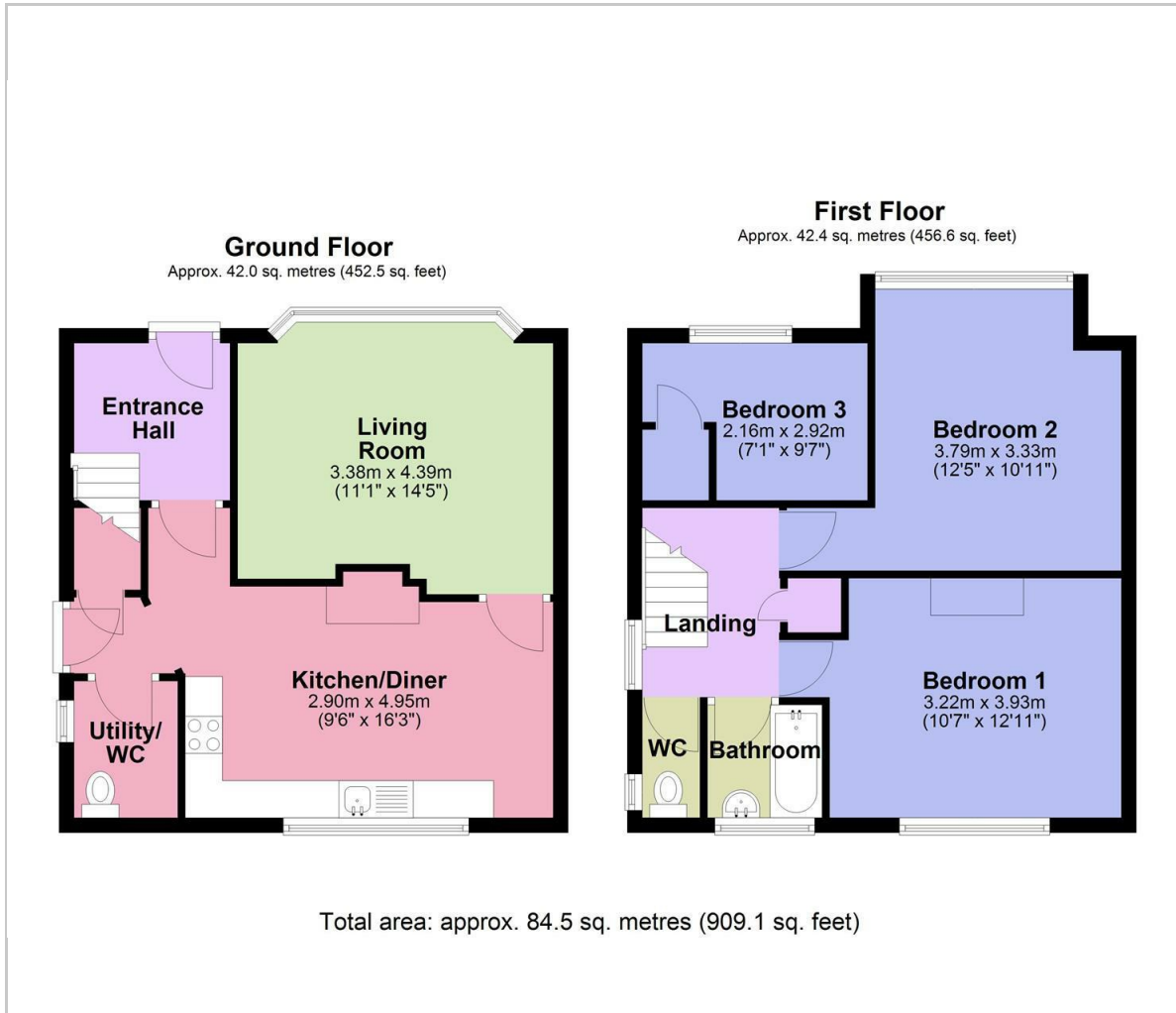

Viewing

Please contact our Maynard Estates Office on 01530 682886 if you wish to arrange a viewing appointment for this property or require further information.

These particulars, whilst believed to be accurate are set out as a general outline only for guidance and do not constitute any part of an offer or contract. Intending purchasers should not rely on them as statements of representation of fact, but must satisfy themselves by inspection or otherwise as to their accuracy. No person in this firm's employment has the authority to make or give any representation or warranty in respect of the property.

2-4 North Street, Whitwick, Coalville, Leicestershire, LE67 5HA
Tel: 01530 682886 Email: sales@maynardestates.co.uk maynardestates.co.uk

Area Map



Energy Efficiency Graph

